

✿ X-tai操作杆分解图

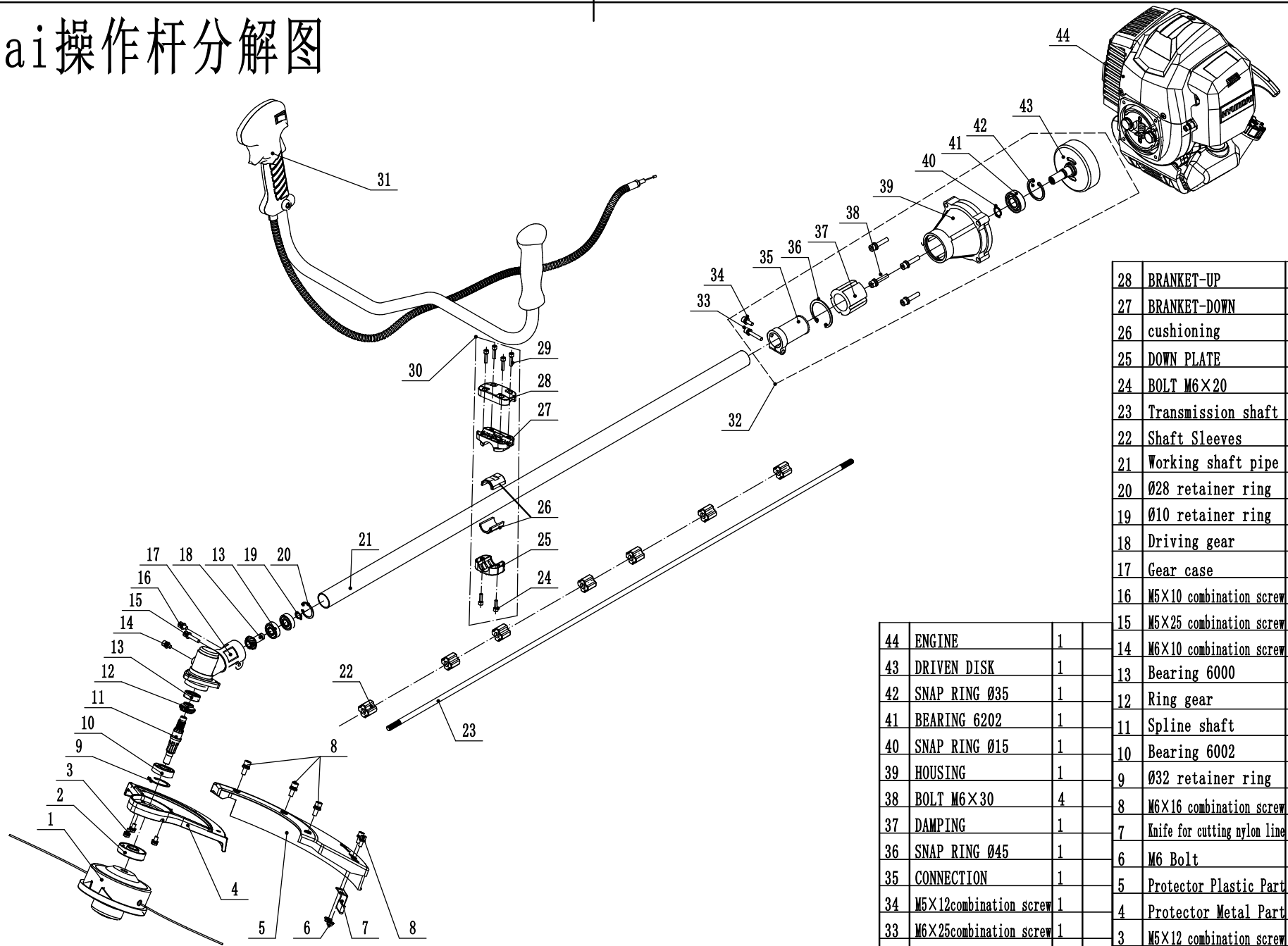

28	BRANKET-UP	1	
27	BRANKET-DOWN	1	
26	cushioning	2	
25	DOWN PLATE	1	
24	BOLT M6×20	2	
23	Transmission shaft	1	
22	Shaft Sleeves	6	
21	Working shaft pipe	1	
20	Ø28 retainer ring	2	
19	Ø10 retainer ring	3	
18	Driving gear	1	
17	Gear case	1	
16	M5×10 combination screw	3	
15	M5×25 combination screw	2	
14	M6×10 combination screw	1	
13	Bearing 6000	3	
12	Ring gear	1	
11	Spline shaft	1	
10	Bearing 6002	2	
9	Ø32 retainer ring	2	
8	M6×16 combination screw	2	
7	Knife for cutting nylon line	1	
6	M6 Bolt	2	
5	Protector Plastic Part	1	
4	Protector Metal Part	1	
3	M5×12 combination screw	3	
2	Down pressing cover	1	
1	Nylon trimmer head	1	
44	ENGINE	1	
43	DRIVEN DISK	1	
42	SNAP RING Ø35	1	
41	BEARING 6202	1	
40	SNAP RING Ø15	1	
39	HOUSING	1	
38	BOLT M6×30	4	
37	DAMPING	1	
36	SNAP RING Ø45	1	
35	CONNECTION	1	
34	M5×12combination screw	1	
33	M6×25combination screw	1	
32	Output seat assembly		
31	RIGHT HANDLE	1	
30	Hand fixed components		
29	BOLT M6×25	4	
序号	名称	数量	备注